



AUXO

USER MANUAL

For further information and query resolution, login to your Auxo App and refer to this icon  in the Help menu to chat with our team representatives (between 10:00 AM to 07:00 PM from Monday to Friday) OR email your queries at:

support@auxo.com.pk



01

SIGN IN & SIGN UP

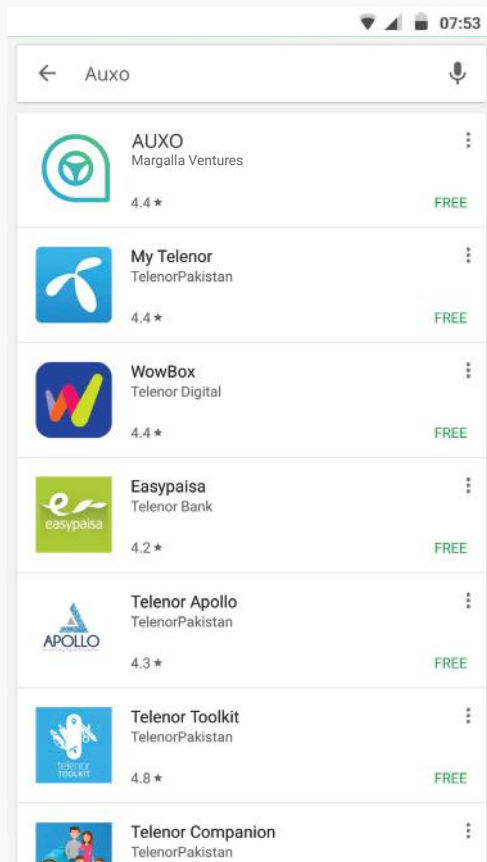

Go to "Google Play Store" or Apple App Store and search for "AUXO"

Click to download and install the app on your smartphone.



Tracking

Track your vehicle in real time



Phone Number



Create Password



Sign In

✓ Sign Up

By Signing Up you agree with our
[Terms and Conditions](#)

Launch the app, type in your Phone Number and Password to Sign Up.

Your password must be atleast 8 characters including numerics, uppercase and lowercase letters.

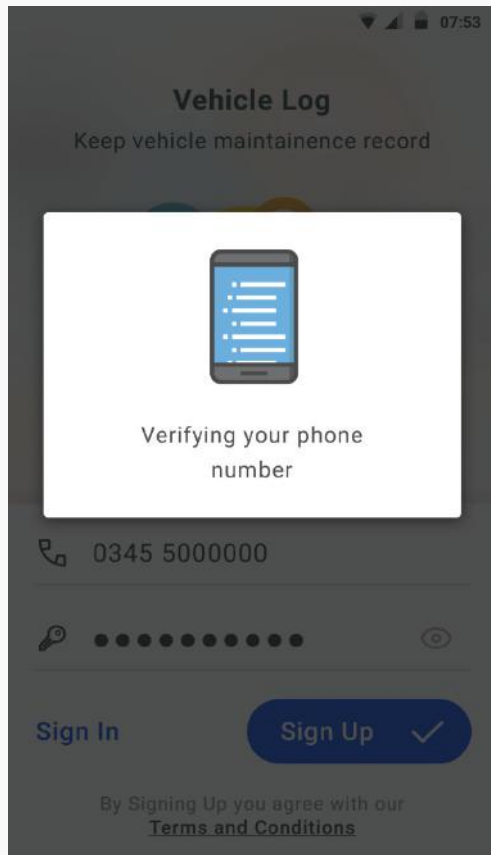

For the purpose of verification, a 4 digit code will be sent to your phone number via SMS.



Sign In



Phone Number



Password



✓ Sign In

[Forgot Password?](#)

To Sign In, re-type your Phone Number and Password.

Your Car

Select Car Make



Toyota



Suzuki



Honda



Others

Select Model Year

2007

2008

2009

2010

2011

Select Model



Corolla GLI



Camry



Camry GLI

✓ Done

Select your car's Make, Year and Model.

In-case your car is not available in the list then click "Others" to manually enter the details.

07:53

Your Car



Car's Plate Number

Retype Plate Number

✓ Done

Corolla GLI Camry Camry GLI

✓ Next

Type your car's plate number. Re-type to confirm.



Kilometer Reading



Kilometer reading will help you
keep track of your fuel
consumption



Enter Kilometers

KM

✓ Next

Enter latest kilometer value from the ODO meter of your car.



To pair your device, please scan the QR code given on the device

OR

[Enter IMEI Number](#)



Scan the QR code pasted at the back of your AUXO device to pair it with your app.

OR

To manually pair your device with the app, click “Enter IMEI Number” and proceed to type the number given on your device.

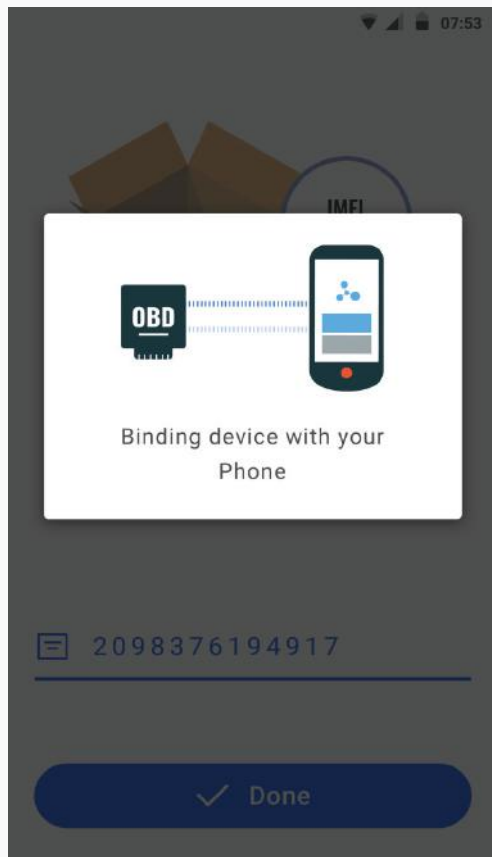

The app will take a few moments to bind the device with your phone



Please plug the OBD device in
OBD-II port of your car

✓ Done



To start monitoring your car, make sure you have plugged the AUXO device in its OBD-II port.



OBD-II Port Locations

The most common locations for the port.

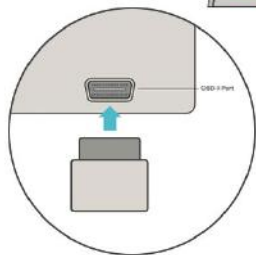

The highlighted regions show the possible OBD-II port locations in which the AUXO device can be plugged.

02

FORGOT PASSWORD



Sign In



Phone Number



Password



✓ Sign In

[Forgot Password?](#)

If you fail to remember your password, go to the Sign In screen and click "Forgot Password."



Phone Number



Please enter your phone number to
continue



Phone Number

Next →

Type in your phone number through which you are registered on the app.



Verification



Please enter the 4 digit pin that
you have received in SMS

0 0 0 0

[Send security pin again?](#)

Reset Password

You will receive a 4 digit security pin via SMS. The security pin will automatically be verified by the app (if not, type in manually).

07:53

< Reset Password

New Password

Retype Password

✓ Done

Type and retype your New Password.

After this you will be directed to the Sign In screen to login with your existing username and new password.

03

DEVICE STATUS

There are 2 **Green** LEDs, one is of Navigate and the other one is of Status.

NAVIGATE STATUS



Navigate LED

Behavior	Meaning
Permanently switched on	GPS signals not received
Blinking every second	Normal mode, GPS is working
Off	GPS is turned off because: Device in deep sleep mode Or GPS antenna malfunctioned

Status LED

Behavior	Meaning
Blinking every second	Normal mode
Blinking every 2 seconds	Deep sleep mode
Blinking fast for a short time	Modem activity
Blinking fast constantly	Boot mode
Off	Device not working Or Device firmware is being flashed

You can also visit our webpage for more details:

www.auxo.com.pk